

INDOOR UNIT

1 SELECT THE BEST LOCATION

(Refer to "Select the best location" section)

2 HOW TO FIX INSTALLATION PLATE

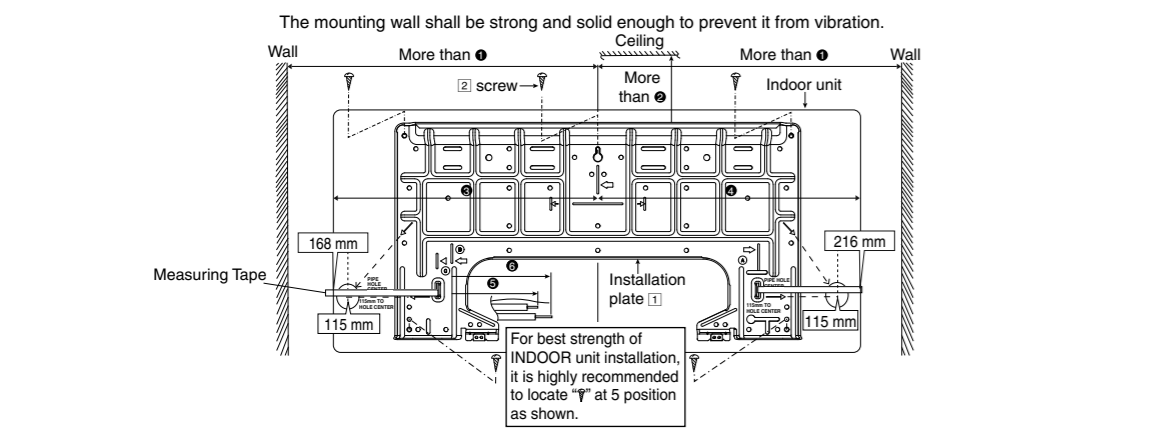

Model	①	②	③	④	⑤	⑥
PZ25***, PZ35***, PZ50***	465 mm	70 mm (+)	365 mm	415 mm	60 mm	120 mm

The center of installation plate should be at more than ① at right and left of the wall. The distance from installation plate edge to ceiling should more than ②. From installation plate center to unit's left side is ③. From installation plate center to unit's right side is ④. For left side piping, piping connection for liquid should be about ⑤ from this line. For right side piping, piping connection for gas should be about ⑥ from this line. The hole center is obtained by measuring the distance, namely 115 mm for left and right hole respectively. (If mounting the unit on the concrete wall, consider using anchor bolts.)

- Always mount the installation plate horizontally by aligning the marking-off line with the thread and using a level gauge.
- Line according to the left and right side of the installation plate. The meeting point of the extended line is the center of the hole.
- Another method is by putting measuring tape at position as shown in the diagram above.
- The hole center is obtained by measuring the distance, namely 115 mm for left and right hole respectively.
- Drill the piping hole at either the right or the left and the hole should be slightly slanting to the outdoor side.

3 TO DRILL A HOLE IN THE WALL AND INSTALL A SLEEVE OF PIPING

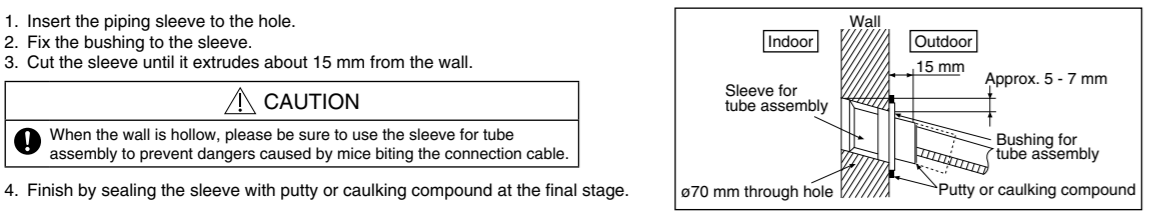

5 CONNECT THE CABLE TO THE INDOOR UNIT

The power supply cord, indoor and outdoor unit connection cable can be connected without removing the front grille.

- Install the indoor unit on the installing holder that mounted on the wall.
- Open the front panel and grille door by loosening the screw.
- Connect the power supply cord and connection cable through Isolating Devices (Disconnecting means).
- Bind all the power supply cord lead wire with tape and route the power supply cord via the left side escapement.
- Connection cable between indoor unit and outdoor unit shall be approved polychloroprene sheathed 4 x 1.5 mm² (1.0 - 1.5HP) or 4 x 2.5 mm² (2.0HP) flexible cord, type designation 60245 IEC 57 or heavier cord.
- Bind all the indoor and outdoor connection cable with tape and route the connection cable via the right side escapement.
- Remove the tapes and connect the power supply cord and connection cable between indoor unit and outdoor unit according to the diagram below.

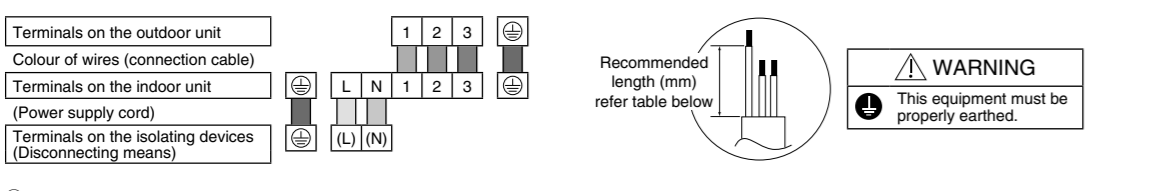

Secure firmly the power supply cord and connecting cable onto the control board with the holder. Do not overtighten holder screw, as this may damage the holder.

Close grille door by tighten with screw and close the front panel.

Isolating Devices (Disconnecting means) should have minimum 3.0 mm contact gap.

Ensure the colour of wires of outdoor unit and the terminal Nos. are the same to the indoor's respectively.

Earth wire shall be Yellow/Green (Y/G) in colour and longer than other AC wires as shown in the figure for the electrical safety in case of the slipping out of the cord from the anchorage.

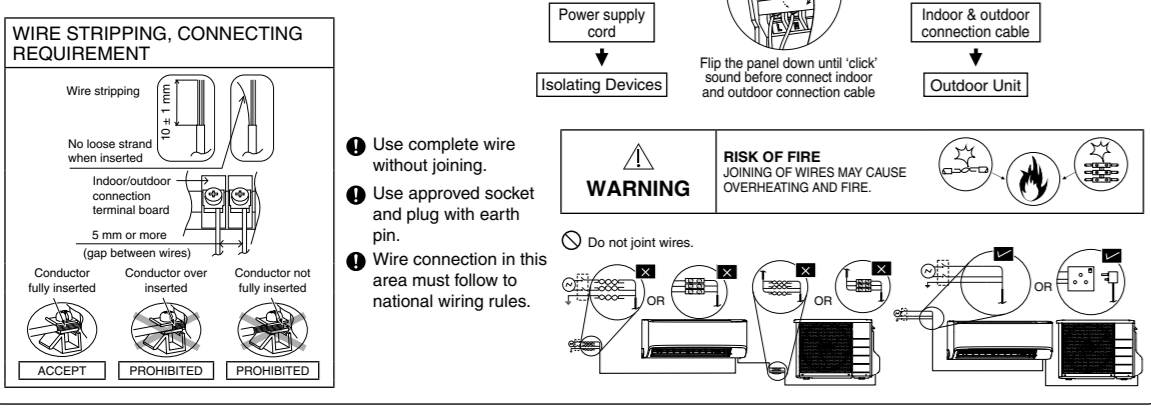

4 INDOOR UNIT INSTALLATION

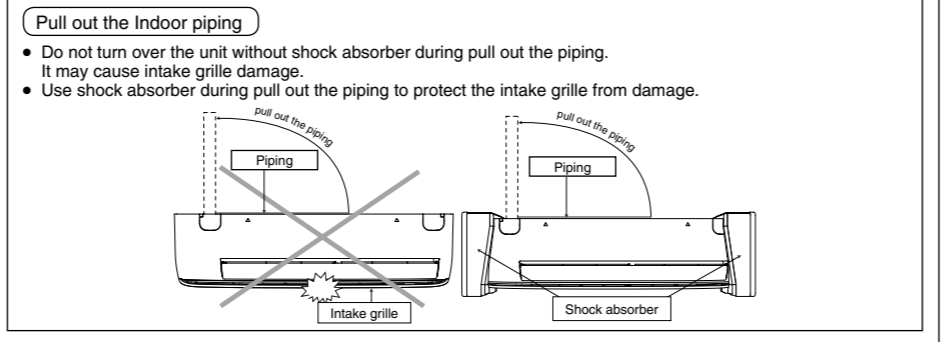

1. FOR THE RIGHT REAR PIPING

Step-1 Pull out the Indoor piping

Step-2 Install the Indoor Unit

Step-3 Secure the Indoor Unit

Step-4 Insert the power supply cord and connection cable

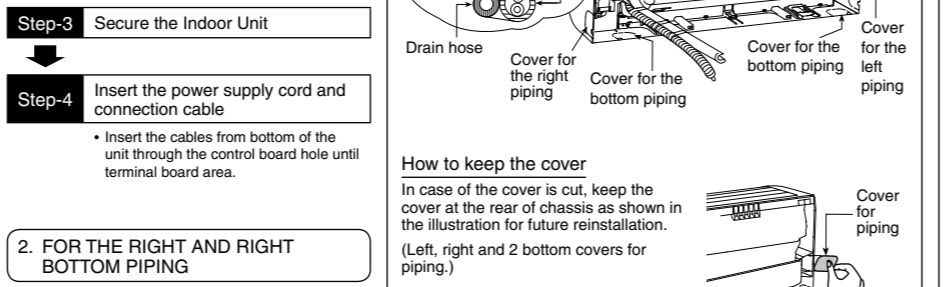

2. FOR THE RIGHT AND RIGHT BOTTOM PIPING

Step-1 Pull out the Indoor piping

Step-2 Install the Indoor Unit

Step-3 Insert the power supply cord and connection cable

Step-4 Secure the Indoor Unit

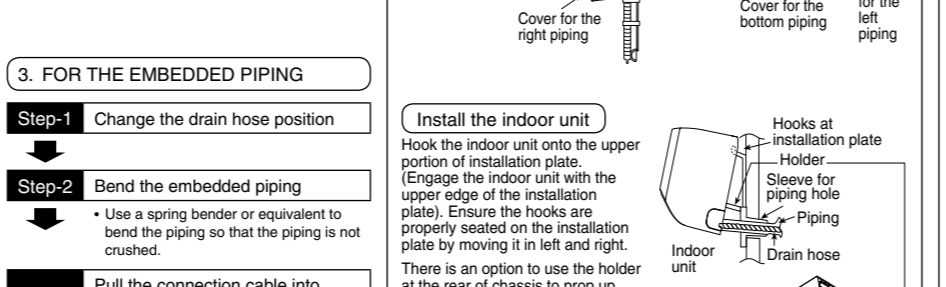

3. FOR THE EMBEDDED PIPING

Step-1 Change the drain hose position

Step-2 Bend the embedded piping

Step-3 Pull the connection cable into Indoor Unit

Step-4 Cut and flare the embedded piping

Step-5 Install the Indoor Unit

Step-6 Connect the piping

Step-7 Insulate and finish the piping

Step-8 Secure the Indoor Unit

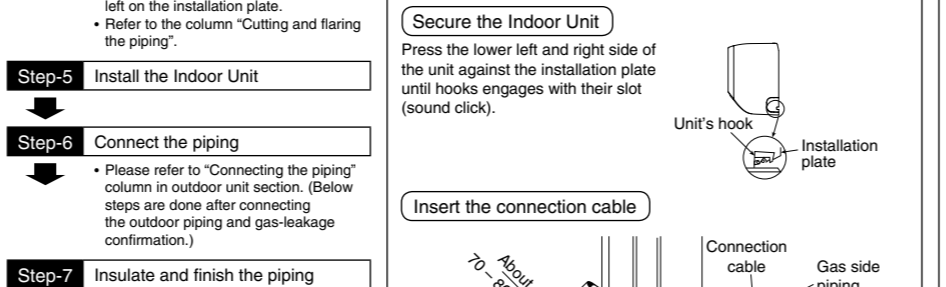

Change the drain hose position

Rear view for left piping installation

Adjust the piping slightly downwards.

Sleeve for piping hole

Drain hose

Connection cable

Piping More than 950 mm

Drain hose

How to pull the piping and drain hose out, in case of the embedded piping.

In case of left piping how to insert the connection cable and drain hose.

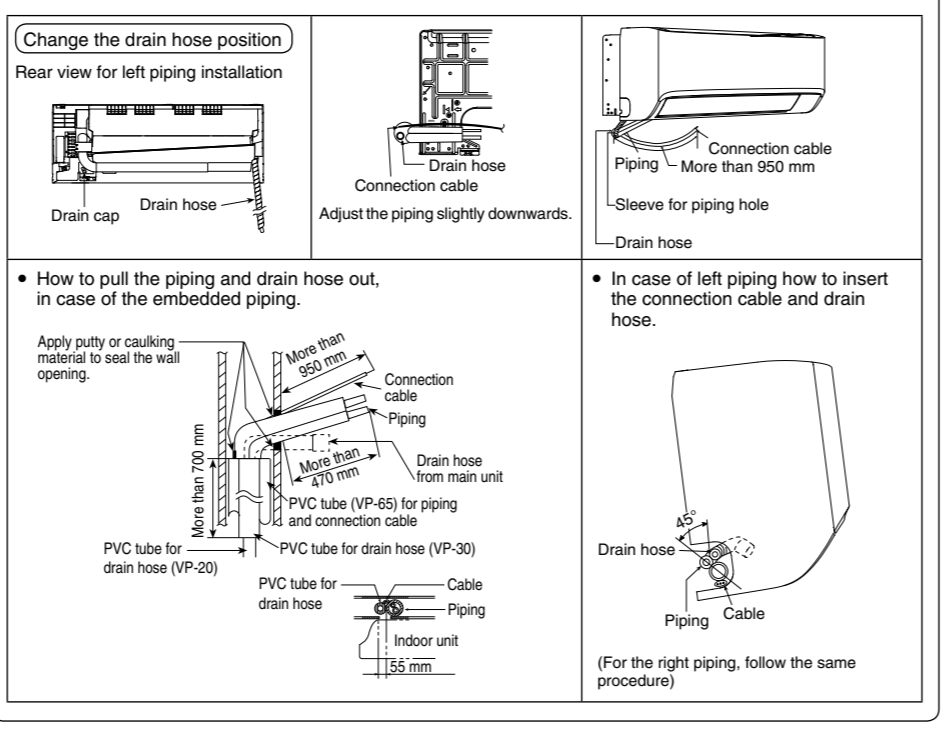

OUTDOOR UNIT

1 SELECT THE BEST LOCATION

(Refer to "Select the best location" section)

2 INSTALL THE OUTDOOR UNIT

After selecting the best location, start installation to Indoor/Outdoor Unit Installation Diagram.

- Fix the unit on concrete or rigid frame firmly and horizontally by bolt nut (φ10 mm).
- Make sure unit install in balance level to ensure that water flow out from unit drainage hole.
- When installing at roof, please consider strong wind and earthquake. Please fasten the installation stand firmly with bolt, screws or nails.

Model	A	B	C	D
PZ25***, PZ35***	570 mm	105 mm	18.5 mm	320 mm
PZ50***	540 mm	160 mm	18.5 mm	330 mm

3 CONNECT THE PIPING

Connecting The Piping to Indoor

For connection joint of all models Please make flare after inserting flare nut (locate at joint portion of tube assembly) onto the copper pipe. (In case of using long piping)

Connect the piping

- Align the center of piping and sufficiently tighten the flare nut with torque wrench
- Further tighten the flare nut with torque wrench in specified torque as stated in the table.

Additional Precautions For R32 Models when connecting by flaring at indoor side

Ensure to do the re-flaring of pipes before connecting to units to avoid leaking.

Seal sufficiently the flare nut (both gas and liquid sides) with neutral cure (Alkoxy type) & ammonia-free silicone sealant along the circumference to avoid the gas leak caused by freezing.

Neutral cure (Alkoxy type) & ammonia-free silicone sealant is only to be applied after pressure testing and cleaning up by following instructions of sealant, only to the outside of the connection. The aim is to prevent moisture from entering the connection joint and possible occurrence of freezing. Curing sealant will take some time. Make sure sealant will not peel off when wrapping the insulation.

Piping size	Torque
6.35 mm (1/4")	[18 N·m (1.8 kgf·m)]
9.52 mm (3/8")	[42 N·m (4.3 kgf·m)]
12.7 mm (1/2")	[55 N·m (5.6 kgf·m)]
15.88 mm (5/8")	[65 N·m (6.6 kgf·m)]
19.05 mm (3/4")	[100 N·m (10.2 kgf·m)]

5 CONNECT THE CABLE TO THE OUTDOOR UNIT

1. Remove the control board cover from the unit by loosening the screw.

2. Connection cable between indoor unit and outdoor unit shall be approved polychloroprene sheathed 4 x 1.5 mm² (1.0 - 1.5HP) or 4 x 2.5 mm² (2.0HP) flexible cord, type designation 60245 IEC 57 or heavier cord. Do not use joint connection cable. Replace the wire if the existing wire (from concealed wiring, or otherwise) is too short.

3. Secure the cable onto the control board with the holder (clamping).

4. Attach the control board cover back to the original position with screw.

5. For wire stripping and connection requirement, refer to instruction ⑤ of indoor unit.

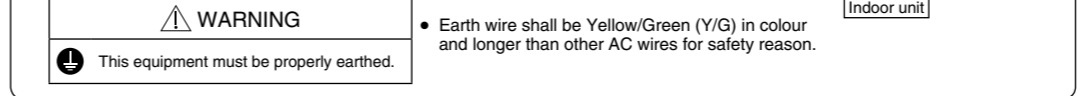

6 PIPING INSULATION

1. Please carry out insulation at pipe connection portion as mentioned in Indoor/Outdoor Unit Installation Diagram. Please wrap the insulated piping end to prevent water from going inside the piping.

2. If drain hose or connecting piping is in the room (where dew may form), please increase the insulation by using POLY-E FOAM with thickness 6 mm or above.

CUTTING AND FLARING THE PIPING

- Please cut using pipe cutter and then remove the burrs.
- Remove the burrs by using reamer. If burrs is not removed, gas leakage may be caused. Turn the piping end down to avoid the metal powder entering the pipe.
- Please make flare after inserting the flare nut onto the copper pipes.

When properly flared, the internal surface of the flare will evenly shine and be of even thickness. Since the flare part comes into contact with the connectors, carefully check the flare finish.

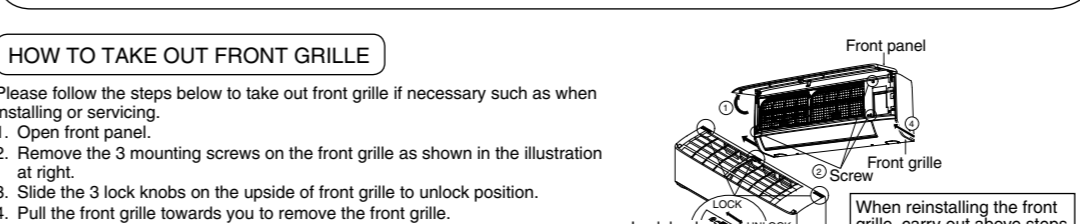

AUTO SWITCH OPERATION

The below operations will be performed by pressing the "AUTO" switch.

- AUTO OPERATION MODE: The Auto operation will be activated immediately once the Auto Switch is pressed and release within 5 sec.
- TEST RUN OPERATION (FOR PUMP DOWN/SERVICING PURPOSE): The Test Run operation will be activated if the Auto Switch is pressed continuously for more than 5 sec. to below 8 sec. A "peep" sound will occur at the fifth sec., in order to identify the starting of Test Run operation.
- HEATING TRIAL OPERATION: Press the "AUTO" switch continuously for more than 8 sec. to below 11 sec. and release when a "peep" sound is occurred at eight sec. (However, a "peep" sound is occurred at fifth sec.). Then press Remote controller "AC Reset" button once. Remote controller signal will activate operation to force heating mode.
- REMOTE CONTROLLER RECEIVING SOUND ON/OFF: The ON/OFF of Remote controller receiving sound can be change over by the following steps:
 - Press "AUTO" switch continuously for more than 16 sec. to below 21 sec.
 - Press the "AC Reset" button once, "peep" sound will occur indicating that Remote controller receiving sound setting mode is activated.
 - Press "AUTO" switch again. Everytime "AUTO" switch is pressed (within 60 sec. interval), Remote controller receiving sound status will be reversed between ON and OFF.
 - Long "peep" sound indicates that Remote controller receiving sound is ON. Short "peep" sound indicates that Remote controller receiving sound is OFF.

HEATING ONLY OPERATION

1) Use remote controller to set heating only operation. When the unit in standby mode, follow the steps below:

- Press **HEAT** continuously for more than 5 seconds to enter special setting mode.
- Press **HEAT** to choose function ①, and then press **HEAT** or **HEAT** to set "01"
- Press **HEAT** to activate "Heating only operation"

4 AIR TIGHTNESS TEST ON THE REFRIGERATING SYSTEM

Do not purge the air with refrigerants but use a vacuum pump to vacuum the installation.

There is no extra refrigerant in the outdoor unit for air purging.

Before system is charged with refrigerant and before the refrigerating system is put into operation, below site test procedure and acceptance criteria shall be verified by the certified technicians, and/or the installer.

Be sure to check whole system for gas leakage.

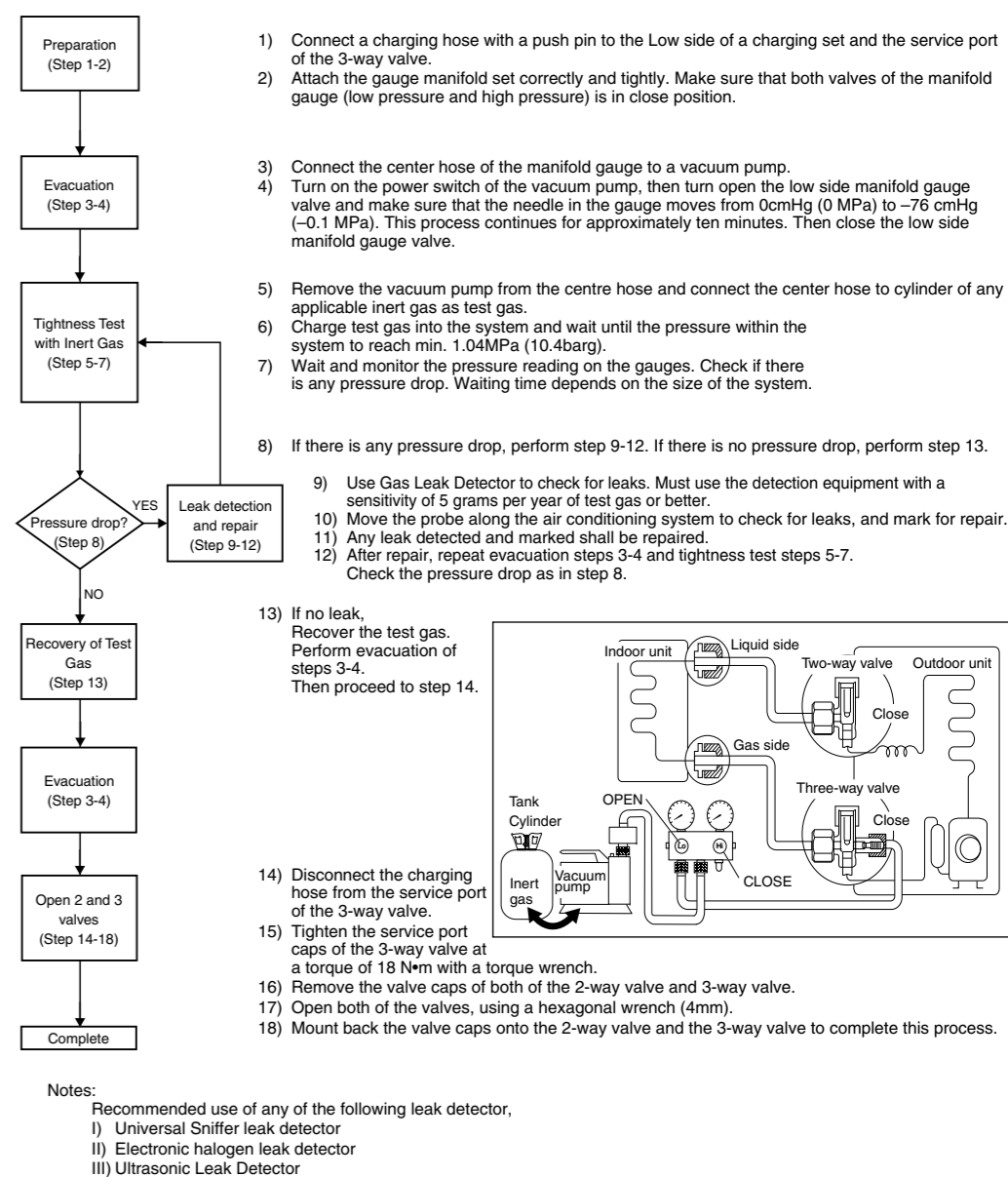

DISPOSAL OF OUTDOOR UNIT DRAIN WATER

If a drain elbow is used, the unit should be placed on a stand which is taller than 3 cm.

If the unit is used in an area where temperature falls below 0°C for 2 or 3 days in succession, it is recommended not to use a drain elbow, for the drain water freezes and the fan will not rotate.

Install the hose at an angle so that the water smoothly flows out.

EVALUATION OF THE PERFORMANCE

Operate the unit at cooling/heating operation mode for fifteen minutes or more.

Measure the temperature of the intake and discharge air.

Ensure the difference between the intake temperature and the discharge is more than 8°C during Cooling operation or more than 14°C during Heating operation.

IN CASE OF REUSING EXISTING REFRIGERANT PIPING

Observe the followings to decide reusing the existing refrigerant piping.

Poor refrigerant piping could result in product failure.

In the circumstances listed below, do not reuse any refrigerant piping. Instead, make sure to install a new piping.

- Heat insulation is not provided for either liquid-side or gas-side piping or both.
- The existing refrigerant pipe has been left in an open condition.
- The diameter and thickness of the existing refrigerant piping does not meet the requirement.
- The piping length and elevation does not meet the requirement.

Perform proper pump down before reuse piping.

In the circumstances listed below, clean it thoroughly before reuse.

- Pump down operation cannot be performed for the existing air-conditioner.
- The compressor has a failure history.
- Oil color is darkened. (ASTM 4.0 and above).
- The existing air-conditioner is gas/oil heat pump type.

Do not reuse the flare to prevent gas leak. Make sure to install a new flare.

If there is a welded part on the existing refrigerant piping, conduct a gas leak check on the welded part.

Replace deteriorated heat insulating material with a new one.

Heat insulating material is required for both liquid-side and gas-side piping.

Proper Pump Down Method

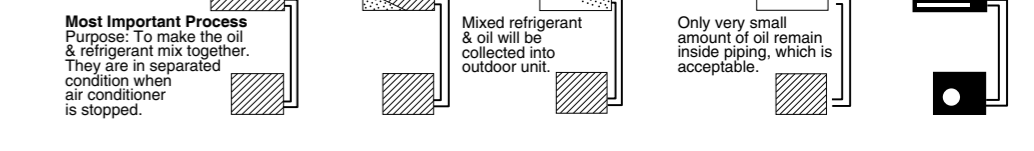

CHECK ITEMS

Is there any gas leakage at flare nut connections?

Has the heat insulation been carried out at flare nut connection?

Is the connection cable being fixed to terminal board firmly?

Is the connection cable being clamped firmly?

Is the drainage ok? (Refer to "Check the drainage" section)

Is the earth wire connection properly done?

Is the indoor unit correctly hooked to the installation plate?

Is the power supply voltage complied with rated value?

Is there any abnormal sound?

Is the cooling/heating operation normal?

Is the thermostat operation normal?

Is the remote control's LCD operation normal?

ВНУТРІШНІЙ БЛОК

1 ВИБЕРІТЬ МІСЦЕ ДЛЯ ВСТАНОВЛЕННЯ

(Див. параграф «Вибірть місце для встановлення»)

2 КРИПЛЕННЯ МОНТАЖНОЇ ПЛАСТИНИ



Центр монтажної пластини повинен бути розташований не ближче, ніж 1 від правого та лівого стіни. Відстань від краю монтажної пластини до стелі повинна бути не меншою, ніж 2. Відстань від центру монтажної пластини до лівого краю блока 3. Відстань від центру монтажної пластини до правого краю блока 4. При лінійному підключенні трубопроводу точка під'єднання рідкого холодоагенту повинна бути на відстані близько 5 від лівої стіни. При лінійному підключенні трубопроводу точка під'єднання труби газоподобного холодоагенту повинна бути на відстані біля 15 від лівої стіни. При лінійному підключенні трубопроводу точка під'єднання труби газоподобного холодоагенту повинна бути на відстані біля 15 від лівої стіни. При лінійному підключенні трубопроводу точка під'єднання труби газоподобного холодоагенту повинна бути на відстані біля 15 від лівої стіни.

3 СВЕРДЛІННЯ ОТВОРУ В СТІНІ ТА ВСТАНОВЛЕННЯ ГІЛЬЗИ ДЛЯ ТРУБОПРОВОДА

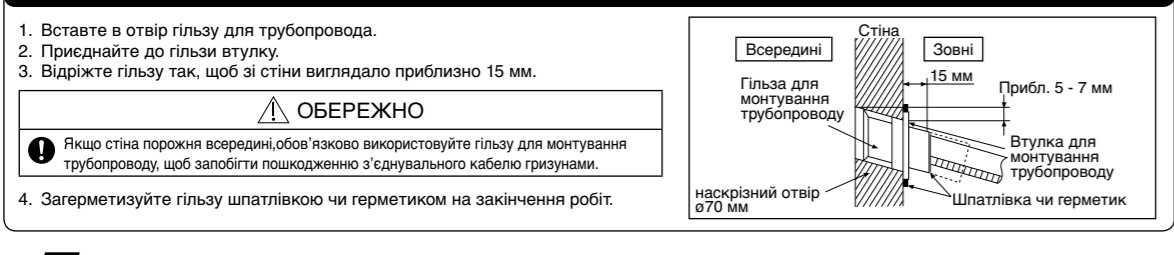

5 ПІД'ЄДНАЙТЕ КАБЕЛЬ ДО ВНУТРІШНЬОГО БЛОКУ

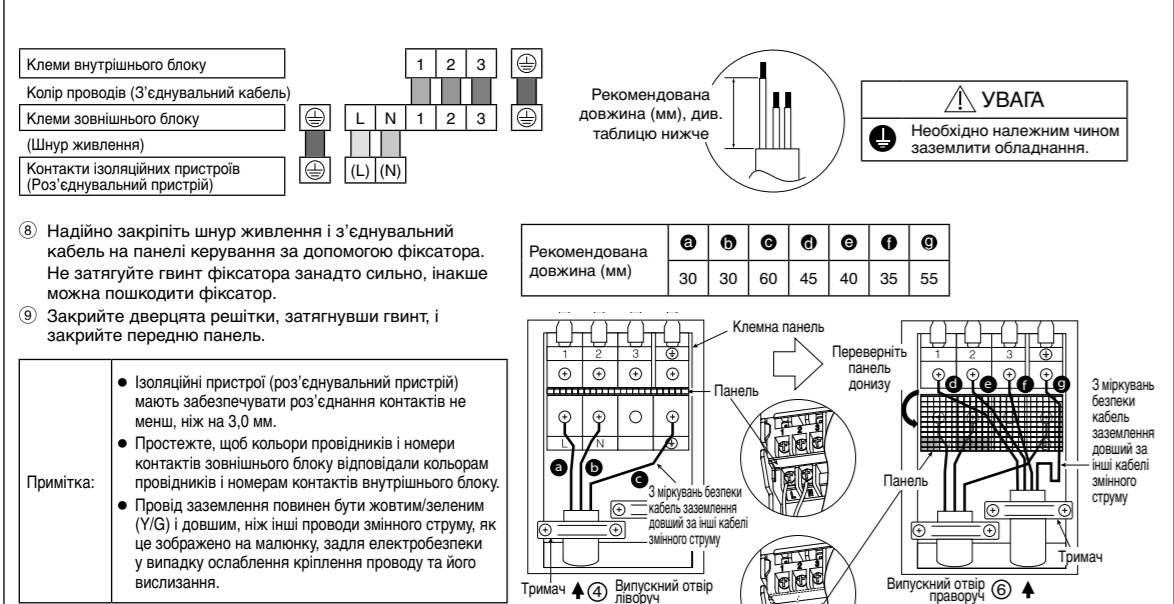
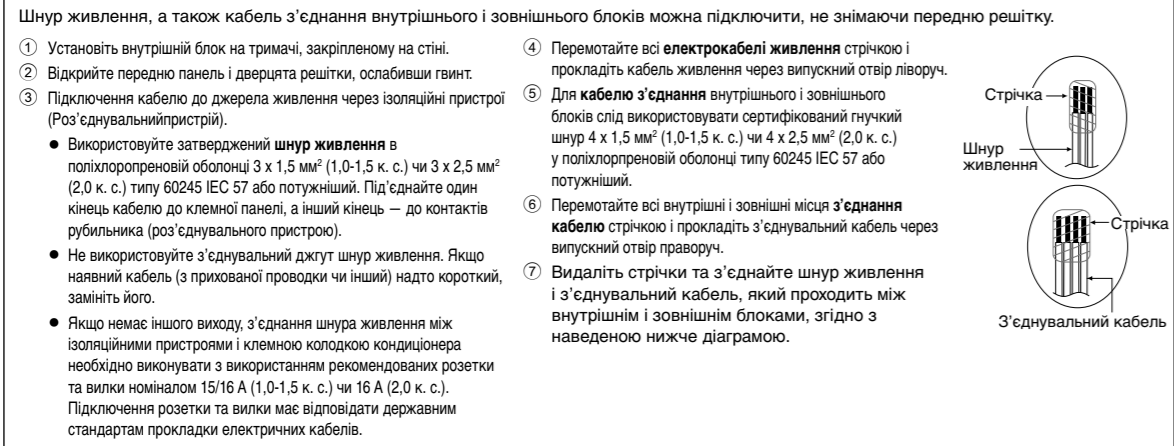

4 МОНТАЖ ВНУТРІШНЬОГО БЛОКУ

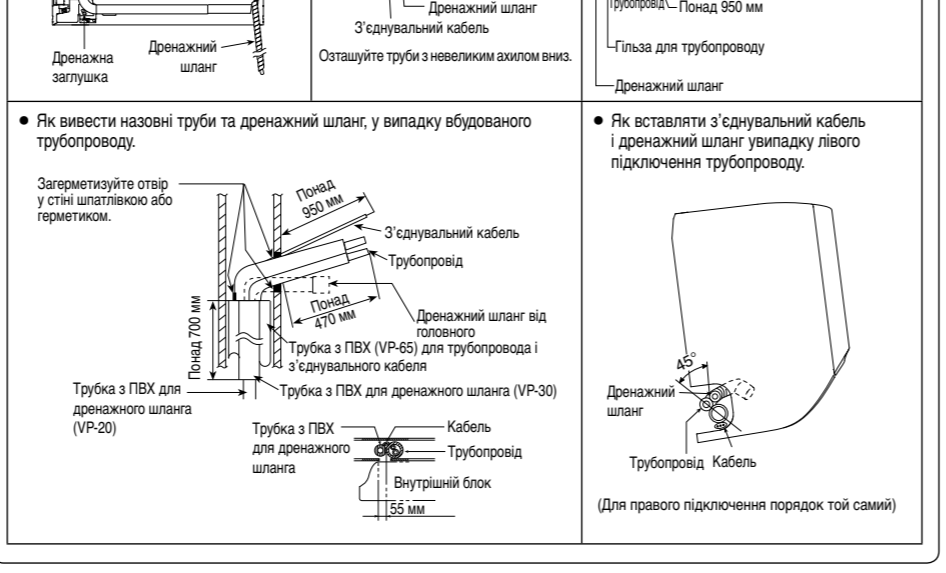
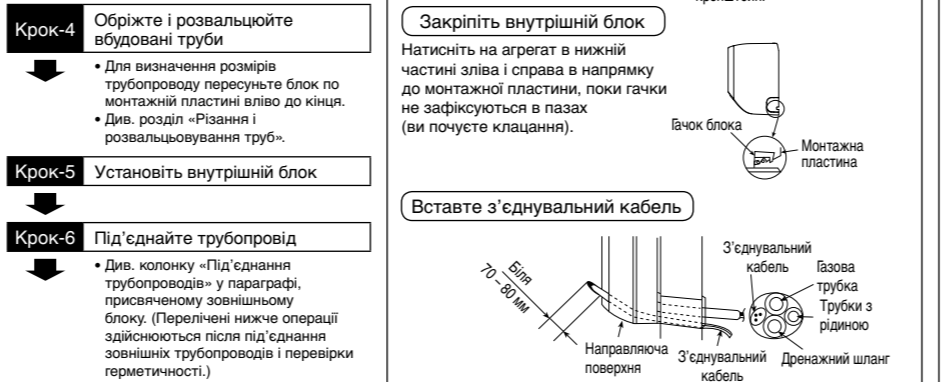
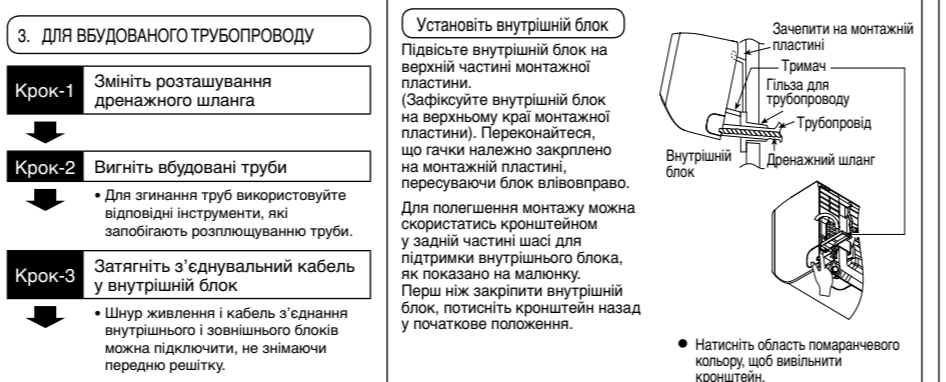
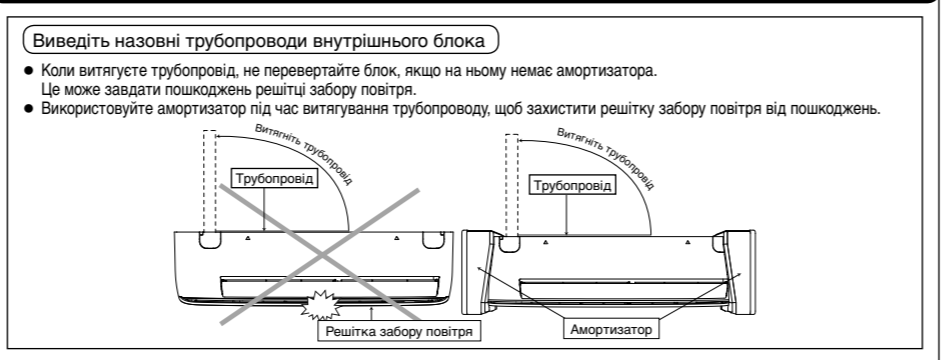

ЗОВНІШНІЙ БЛОК

1 ВИБЕРІТЬ МІСЦЕ ДЛЯ ВСТАНОВЛЕННЯ

(Див. параграф «Вибірть місце для встановлення»)

2 УСТАНОВІТЬ ЗОВНІШНІЙ БЛОК

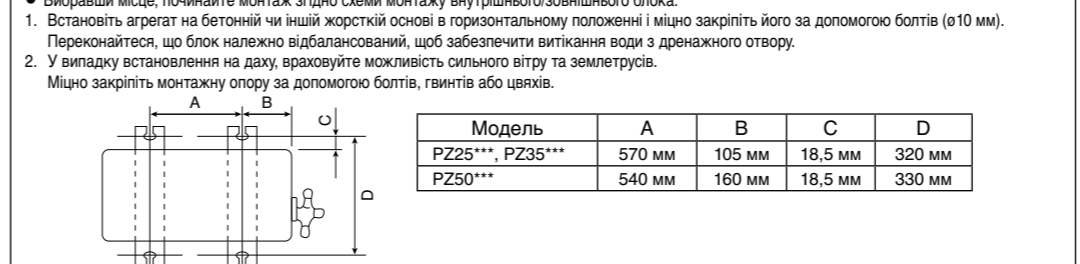

3 ПІД'ЄДНАННЯ ТРУБОПРОВОДУ

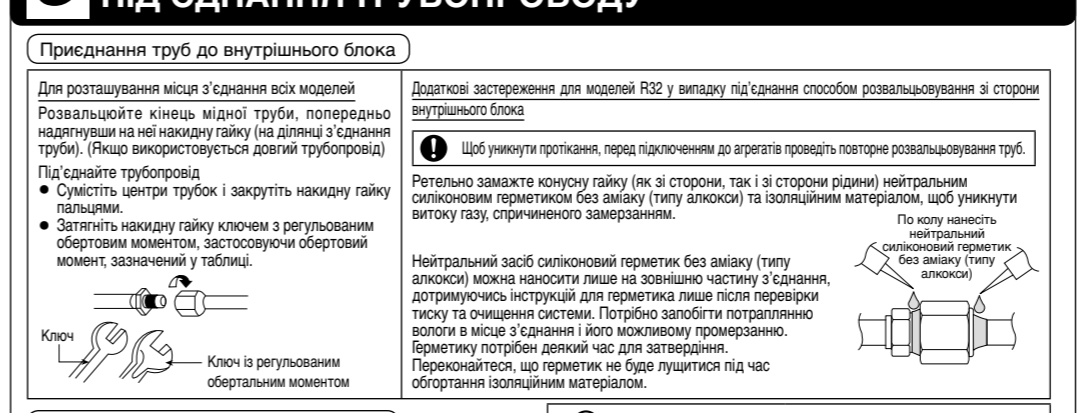

5 ПІД'ЄДНАЙТЕ КАБЕЛЬ ДО ЗОВНІШНЬОГО БЛОКУ

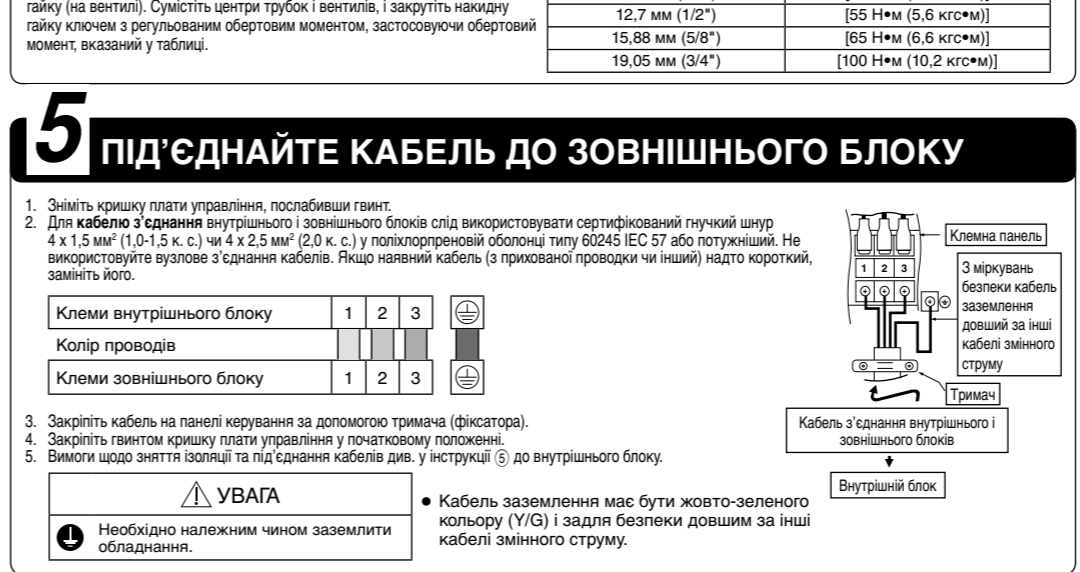

6 ІЗОЛЯЦІЯ ТРУБ

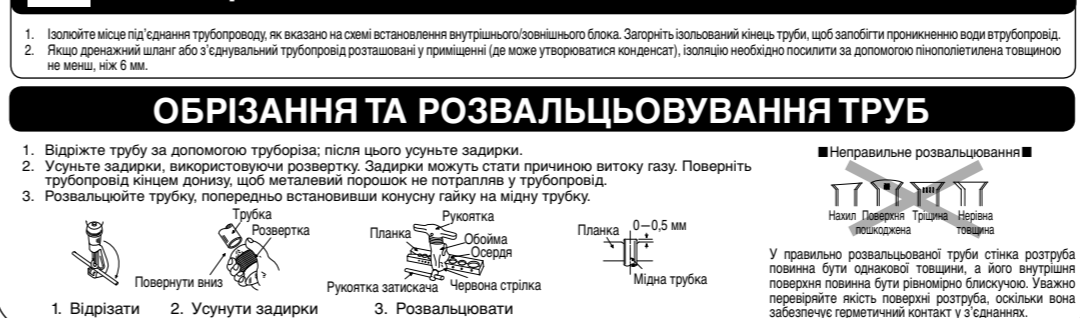

ЯК ЗНЯТИ ПЕРЕДНЮ РЕШІТКУ

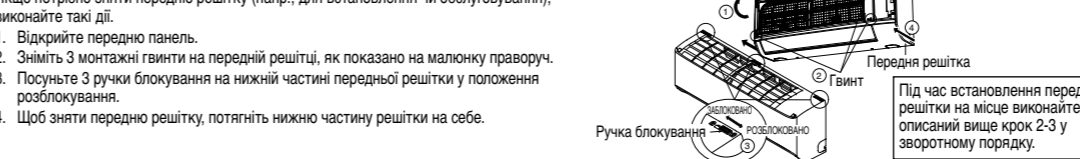

ВИКОРИСТАННЯ КНОПКИ «АУТО»

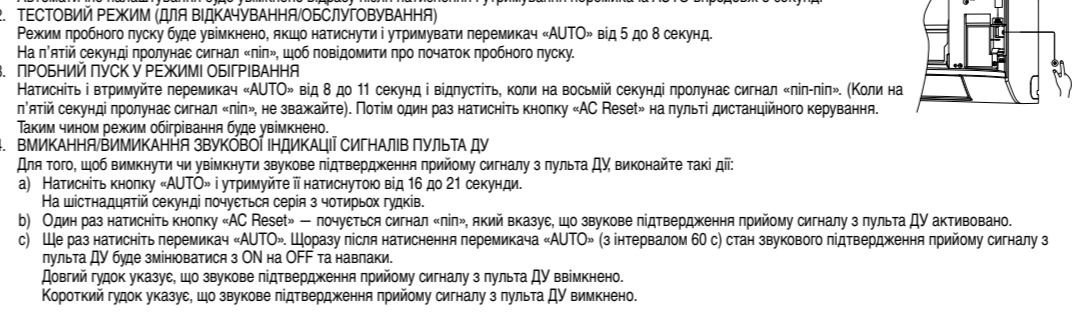

РЕЖИМ ЛИШЕ ОБІГРІВАННЯ

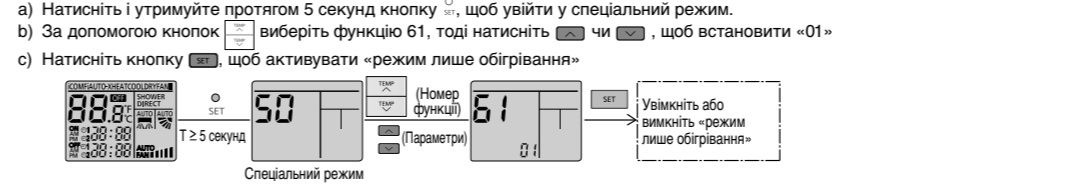

СПОСІБ ПРОДУВАННЯ ПОВІТРЯМ ЗАБОРОНЕНИЙ ДЛЯ СИСТЕМИ R32

4 ВІПРОБОВУВАННЯ СИСТЕМИ ОХОЛОДЖЕННЯ НА ГЕРМЕТИЧІСТЬ

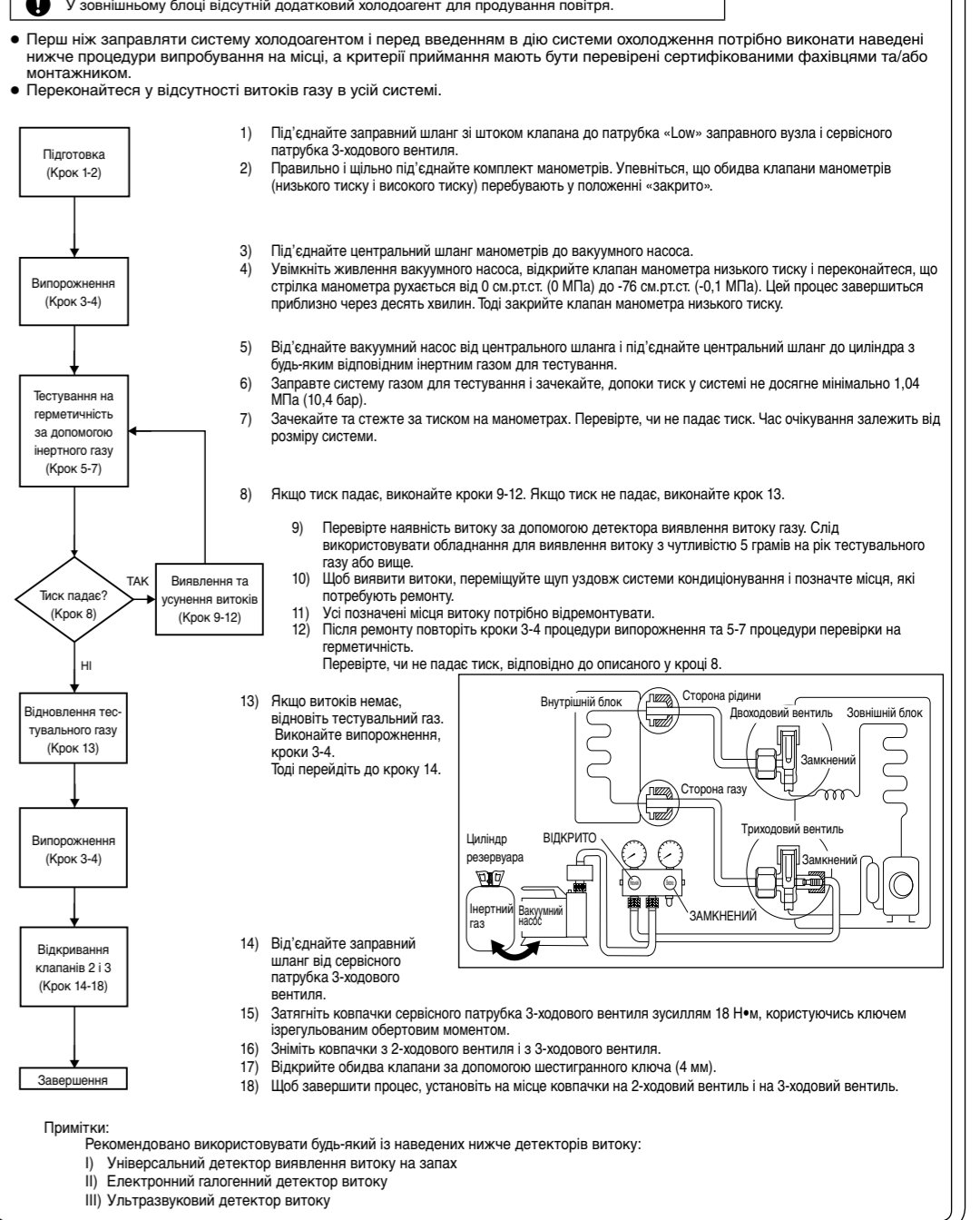

ВІДВЕДЕННЯ ВОДИ З ЗОВНІШНЬОГО БЛОКУ

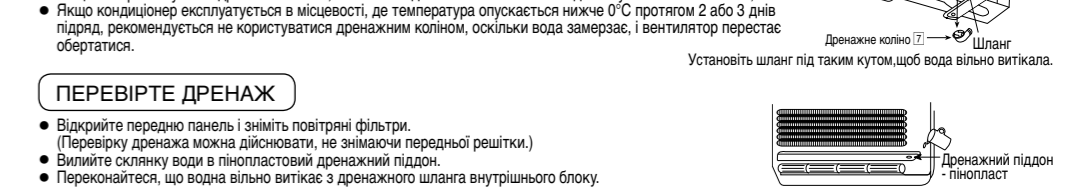

ПЕРЕВІРТЕ ДРЕНАЖ

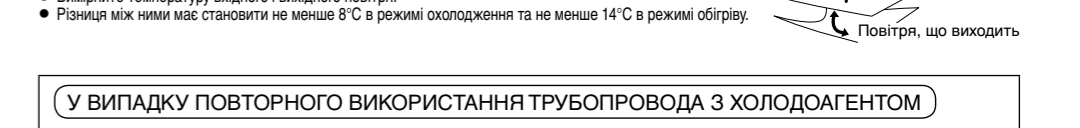

ПЕРЕВІРТЕ РОБОТИ

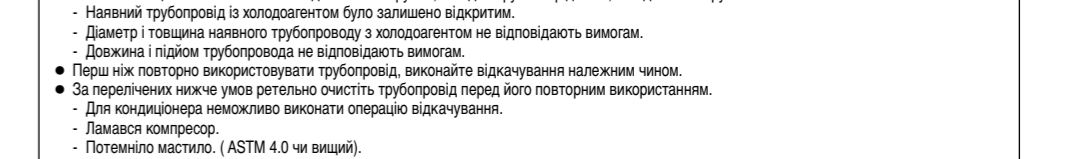

У ВИПАДКУ ПОВТОРНОГО ВИКОРИСТАННЯ ТРУБОПРОВОДА З ХОЛОДАГЕНТОМ

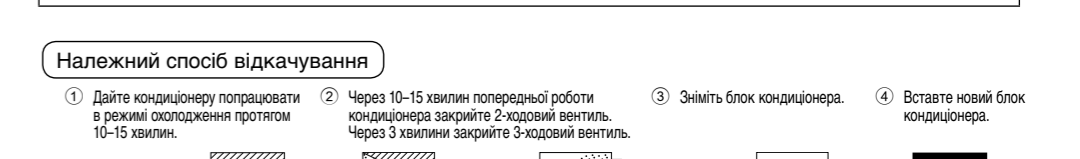

Надійний спосіб відкачування

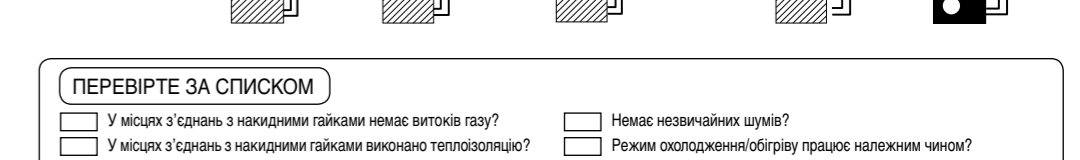

ПЕРЕВІРТЕ ЗА СПИСОКОМ

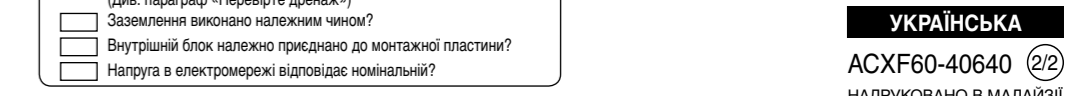

1 ҚОЛАЙЛЫ ОРЫНДЫ ТАҢДАУ

2 ОРНАТУ ТАҚТАСЫН БЕКІТУ ӘДІСІ

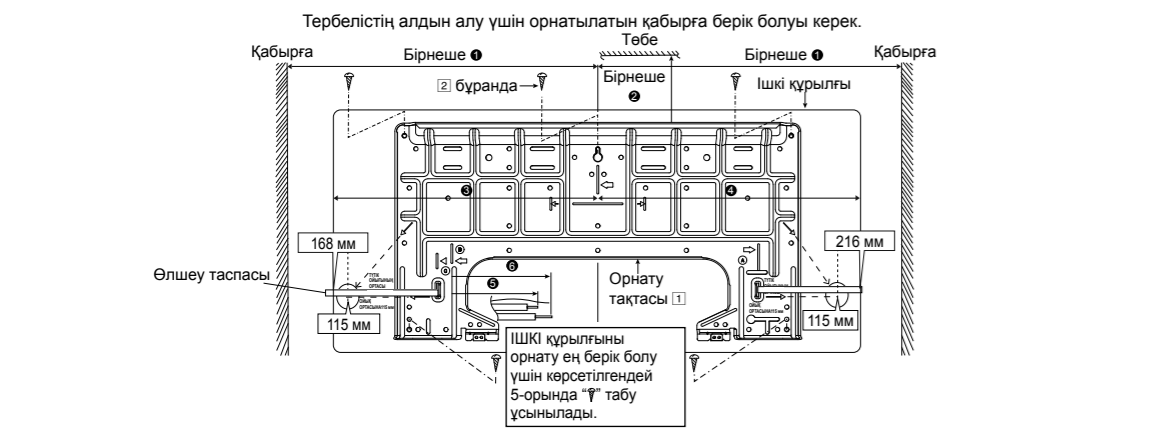

Table with columns for Model (PZ25, PZ35, PZ50) and Dimensions (Өлшемдері) in mm.

Орнату тақтасының ортасы қабырғаның оң және сол жағынан 1 артық болуы керек. Орнату тақтасының шеті және төбе арасындағы қашықтық 2 артық болуы қажет.

3 ҚАБЫРҒАДА ОЙЫҚ БҰРҒЫЛАУ ЖӘНЕ ТҮТІК ТЫҒЫНЫН ОРНАТУ



5 КАБЕЛЬДІ ІШКІ ҚҰРАЛҒА ҚОСУ

Text instructions for internal wiring, including steps 1-9 and a table for cable lengths (Ұзындығын ұзындық (мм) үшін төмендегі кестені қараңыз).

Diagram of terminal block connection with labels like 'Сыртқы қабаттағы шығыстар', 'Ішкі құралдағы шығыстар', and 'Оқшаулау құрылғыларындағы шығыстар'.

4 ІШКІ ҚҰРАЛДЫ ОРНАТУ

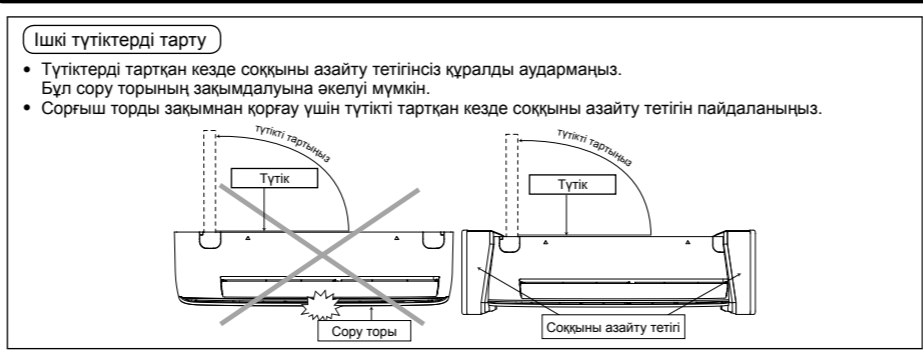

Step-by-step instructions (1-8) for internal unit installation, including diagrams for cable connection and unit placement.

Diagram showing the connection of the cable to the internal unit, with labels for 'Қосылым кабелін енгізу', 'Құралдың ілмегі', and 'Орнату тақтасы'.

Diagram showing the connection of the cable to the external unit, with labels for 'Төгу шлангісінің күйін өзгерту', 'Дренаж қапталы', 'Қосылым кабелі', and 'Түтік ойығының тығыны'.

1 ҚОЛАЙЛЫ ОРЫНДЫ ТАҢДАУ

2 СЫРТҚЫ ҚҰРАЛДЫ ОРНАТУ

Table with columns for Model (PZ25, PZ35, PZ50) and Dimensions (A, B, C, D) in mm.

3 ТҮТІКТЕРДІ ҚОСУ

Diagram showing the connection of the pipe to the external unit, with labels for 'Түтіктерді ішкі құралға қосу' and 'Түтіктерді сыртқы құралға қосу'.

Table with columns for Model (PZ25, PZ35, PZ50) and Dimensions (Түтік өлшемі) in mm.

5 КАБЕЛЬДІ СЫРТҚЫ ҚҰРАЛҒА ҚОСУ

Diagram showing the connection of the cable to the external unit, with labels for 'Сыртқы құралдағы шығыстар' and 'Ішкі құралдағы шығыстар'.

6 ТҮТІК ОҚШАУЛАУЫ

Diagram showing the insulation of the pipe with labels for 'Түтік', 'Төгу шлангісі', and 'Дренаж қапталы'.

Diagram showing the connection of the cable to the external unit, with labels for 'Құралды шығару үшін', 'Төгу шлангісінің күйін өзгерту', and 'Қосылым кабелі'.

Diagram showing the connection of the cable to the external unit, with labels for 'Төгу шлангісінің күйін өзгерту', 'Дренаж қапталы', and 'Қосылым кабелі'.

Diagram showing the connection of the cable to the external unit, with labels for 'Төгу шлангісінің күйін өзгерту', 'Дренаж қапталы', and 'Қосылым кабелі'.

Diagram showing the connection of the cable to the external unit, with labels for 'Төгу шлангісінің күйін өзгерту', 'Дренаж қапталы', and 'Қосылым кабелі'.

Diagram showing the connection of the cable to the external unit, with labels for 'Төгу шлангісінің күйін өзгерту', 'Дренаж қапталы', and 'Қосылым кабелі'.

4 ТОНАЗЫТҚЫШ ЖҮЙЕСІНІҢ АУА ӨТКІЗІШТІК СЫНАҒЫ

Flowchart for the vacuum system leak test, including steps 1-17 and a diagram of the system components.

Diagram showing the connection of the cable to the external unit, with labels for 'Сыртқы құралдағы шығыстар' and 'Ішкі құралдағы шығыстар'.

Diagram showing the connection of the cable to the external unit, with labels for 'Сыртқы құралдағы шығыстар' and 'Ішкі құралдағы шығыстар'.

Diagram showing the connection of the cable to the external unit, with labels for 'Сыртқы құралдағы шығыстар' and 'Ішкі құралдағы шығыстар'.

Diagram showing the connection of the cable to the external unit, with labels for 'Сыртқы құралдағы шығыстар' and 'Ішкі құралдағы шығыстар'.

Diagram showing the connection of the cable to the external unit, with labels for 'Сыртқы құралдағы шығыстар' and 'Ішкі құралдағы шығыстар'.

Diagram showing the connection of the cable to the external unit, with labels for 'Сыртқы құралдағы шығыстар' and 'Ішкі құралдағы шығыстар'.

Diagram showing the connection of the cable to the external unit, with labels for 'Сыртқы құралдағы шығыстар' and 'Ішкі құралдағы шығыстар'.

Diagram showing the connection of the cable to the external unit, with labels for 'Сыртқы құралдағы шығыстар' and 'Ішкі құралдағы шығыстар'.

Diagram showing the connection of the cable to the external unit, with labels for 'Сыртқы құралдағы шығыстар' and 'Ішкі құралдағы шығыстар'.

ՆԵՐՔԻՆ ԲԼՈՎ

1 ԸՆՏՐՏԵ ԱՌԱՎԵԼԱԳՈՒՅՆ ՀԱՐՄԱՐ ՎԱՅՐԸ (Տես Ընտրել առավելագույն հարմար վայրեր բաժինը)

2 ԻՆՉՊԵՍ ԱՐՄԱՅՆԵԼ ՏԵՂԱԴՐՈՒՄ ՎԱՅՆԱԿԸ

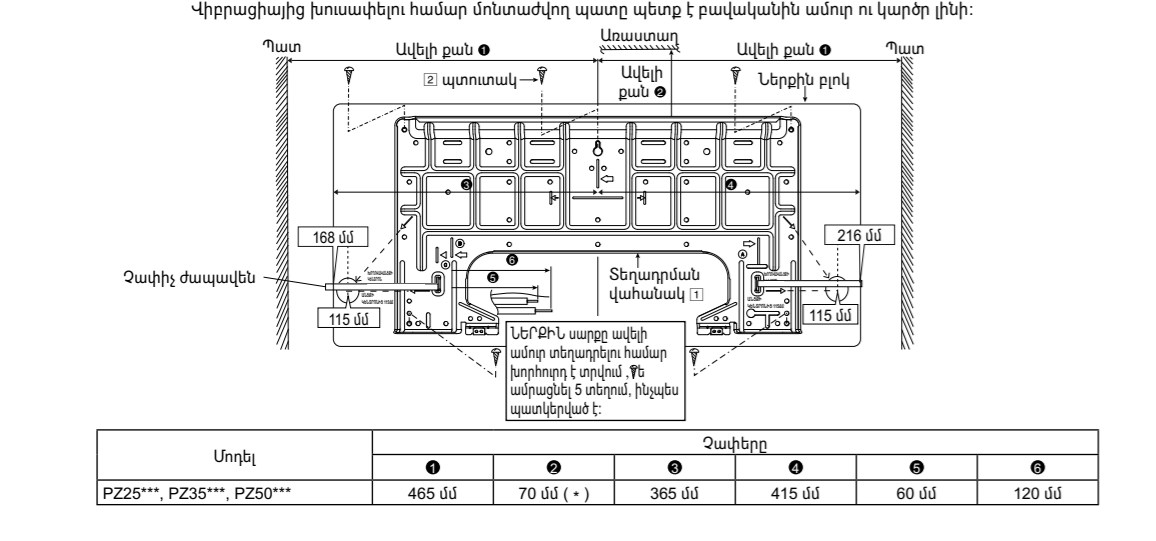

Տեղադրման վահանակի կենտրոնը պետք է լինի ավելի քան 1 հեռավորության վրա պատից և ձախ կոնքից:
Տեղադրման վահանակի ձախից մինչև առաստաղի հեռավորությունը պետք է լինի ավելի քան 2:
Տեղադրման վահանակի կենտրոնից մինչև սարքի ձախ մասը մասը 3:
Տեղադրման վահանակի կենտրոնից մինչև սարքի աջ մասը 4:
Չափիչը 5: Ձախից 6:
Ձախից 7:
Ձախից 8:
Ձախից 9:
Ձախից 10:
Ձախից 11:
Ձախից 12:

3 ՊԱՇԻ ՄԵՋ ԱՆՋՔ ԲԱՅԵԼԸ և ԽՈՐՈՎԱԿՆԵՐԻ ԿՅՈՐԴԻՉԻ ՏԵՂԱԳՐՈՒՄ

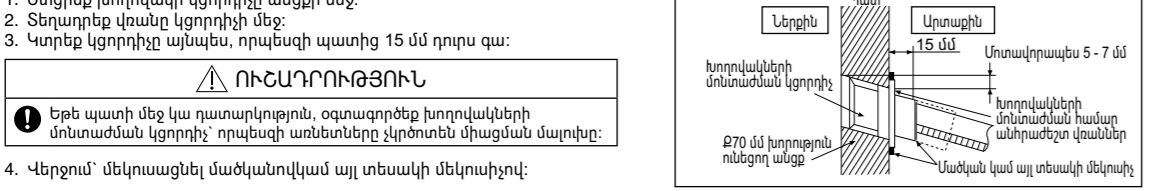

5 ՄԻԱՅՐԵ ՄԱԼՈՒԻԸ ՆԵՐՔԻՆ ԲԼՈՎԻՆ

- Տեղադրման վահանակի կենտրոնը պետք է լինի ավելի քան 1 հեռավորության վրա պատից և ձախ կոնքից:
- Տեղադրման վահանակի ձախից մինչև սարքի ձախ մասը մասը 3:
- Տեղադրման վահանակի կենտրոնից մինչև սարքի աջ մասը մասը 4:
- Չափիչը 5: Ձախից 6: Ձախից 7: Ձախից 8: Ձախից 9: Ձախից 10: Ձախից 11: Ձախից 12:

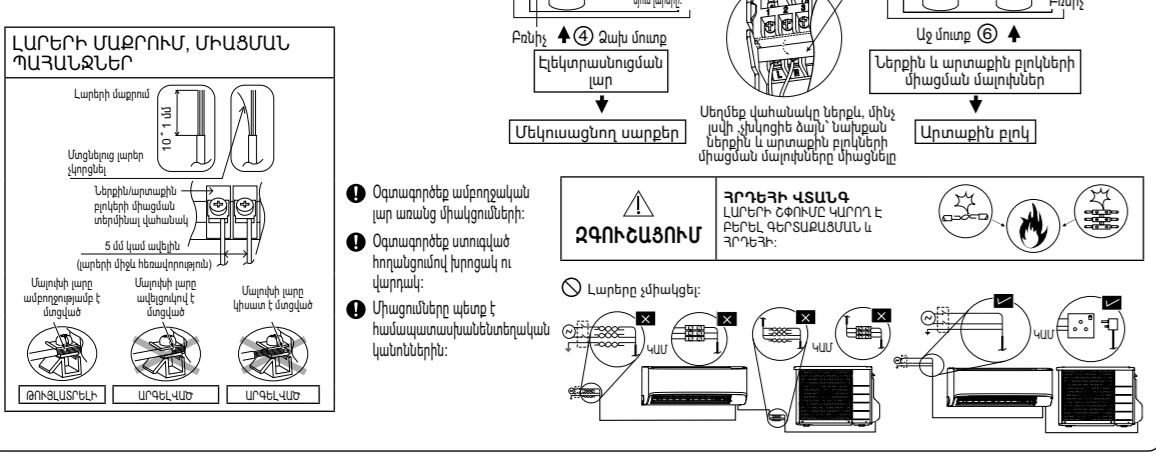
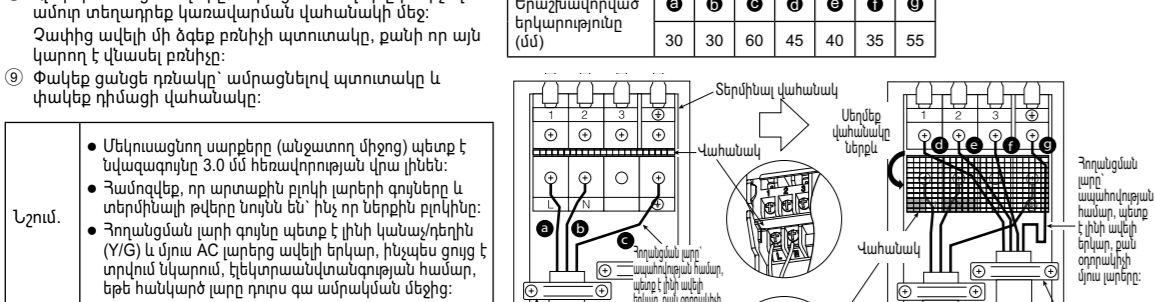
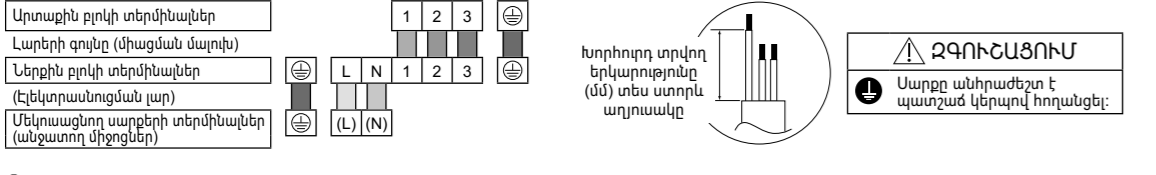

4 ՆԵՐՔԻՆ ԲԼՈՎԻ ՏԵՂԱԳՐՈՒՄ

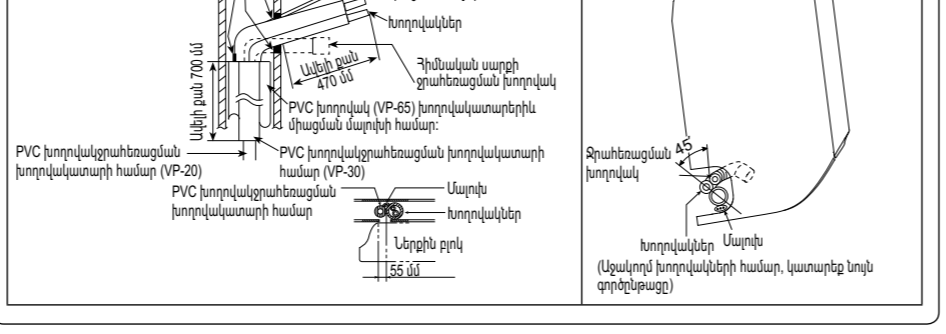
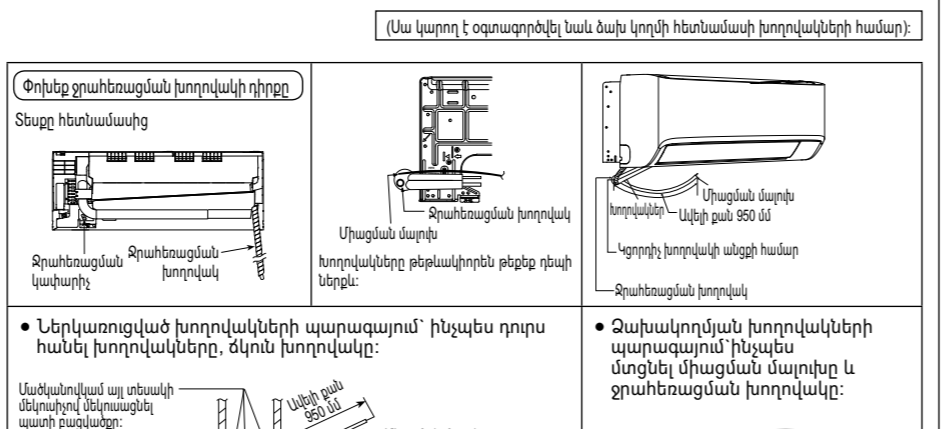
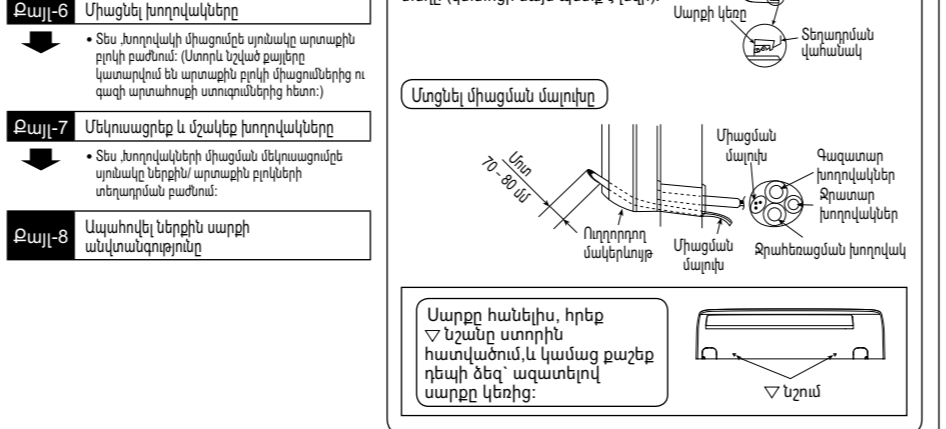
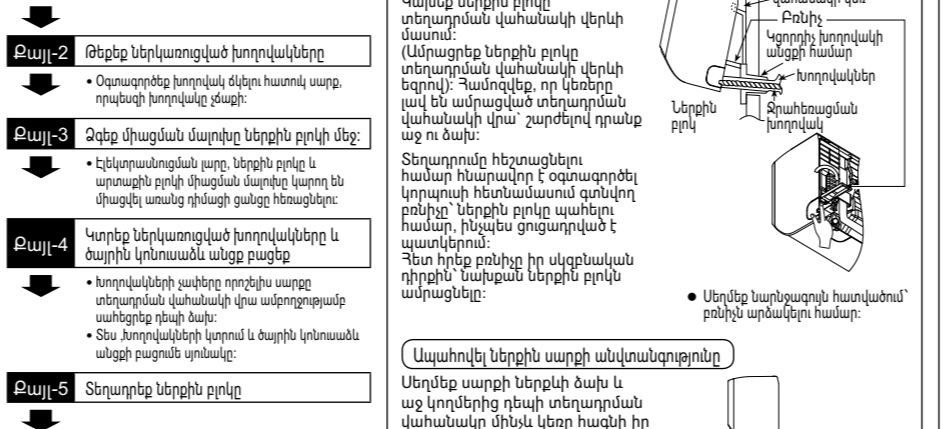
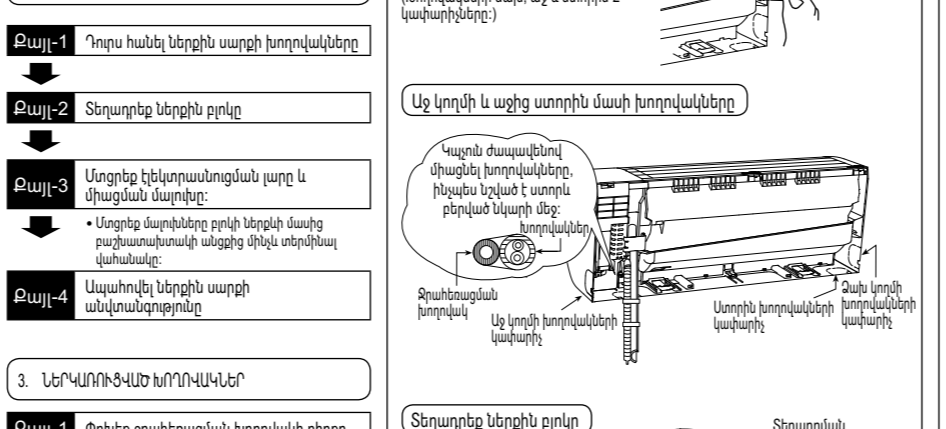
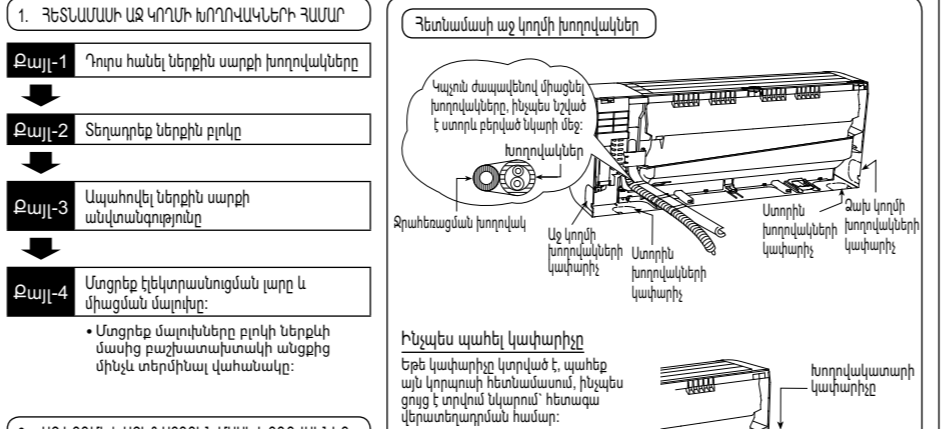
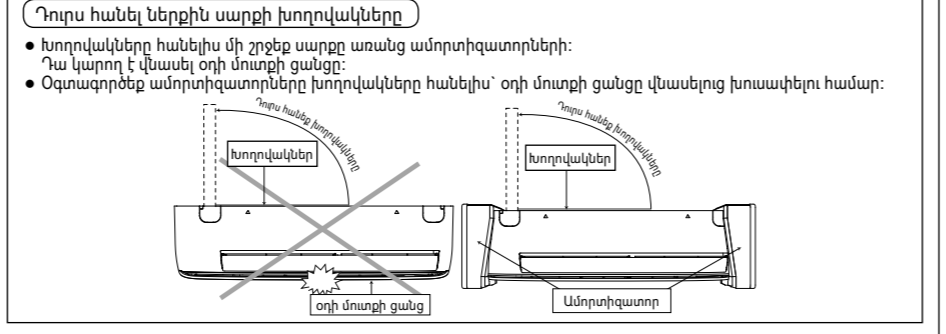

1 ԸՆՏՐՏԵ ԱՌԱՎԵԼԱԳՈՒՅՆ ՀԱՐՄԱՐ ՎԱՅՐԸ (Տես Ընտրել առավելագույն հարմար վայրեր բաժինը)

2 ՏԵՂԱԳՐԵԼ ԱՐՏԱՔԻՆ ԲԼՈՎ

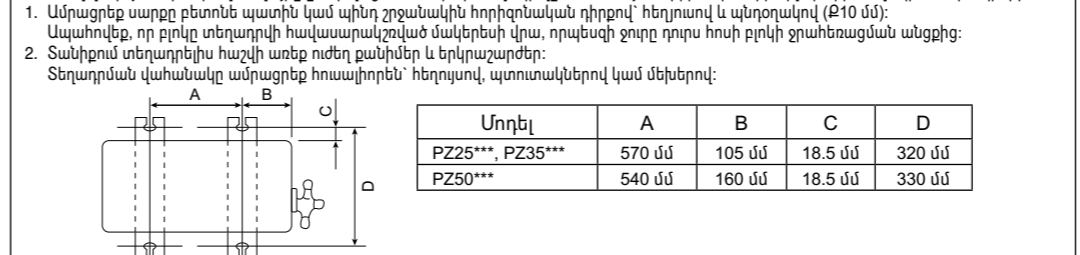

3 ՄԻԱՅՆԵԼ ԽՈՐՈՎԱԿՆԵՐԸ

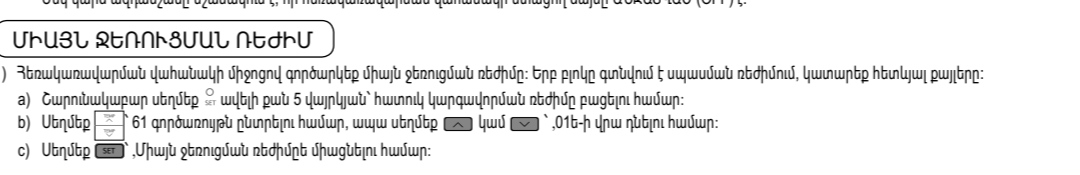
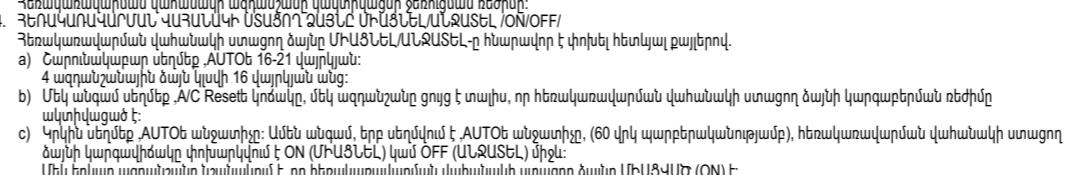
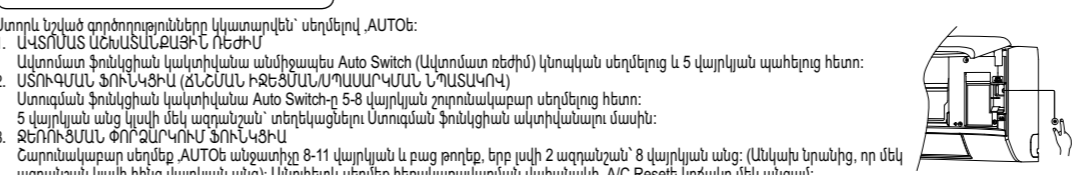
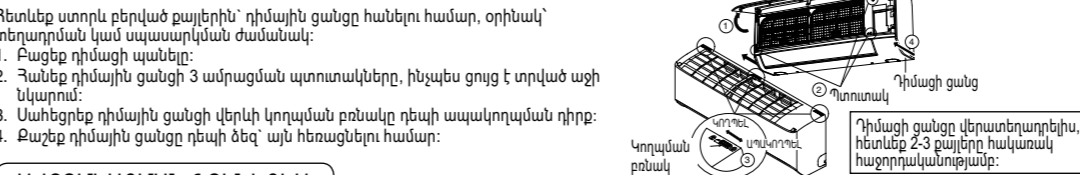
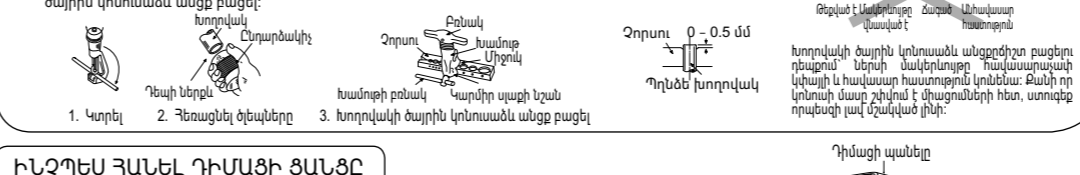
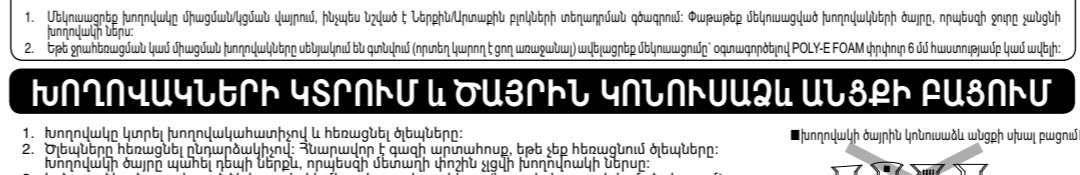
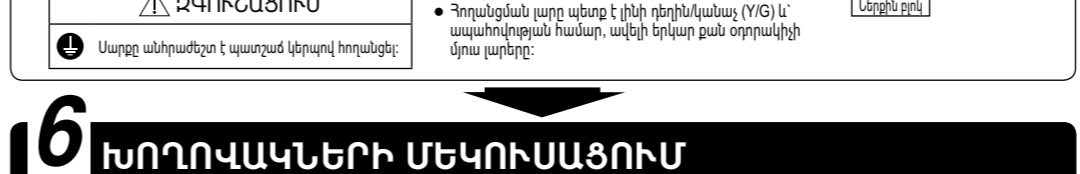
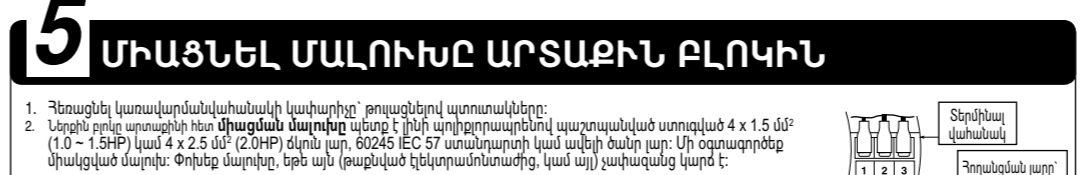
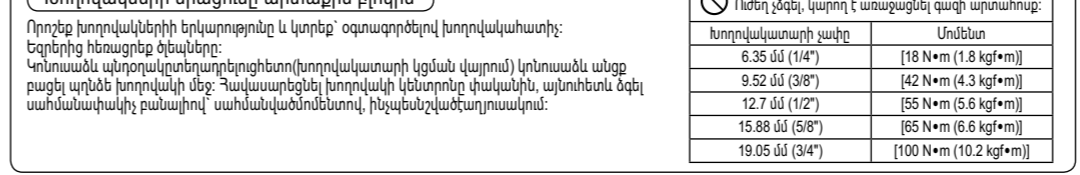
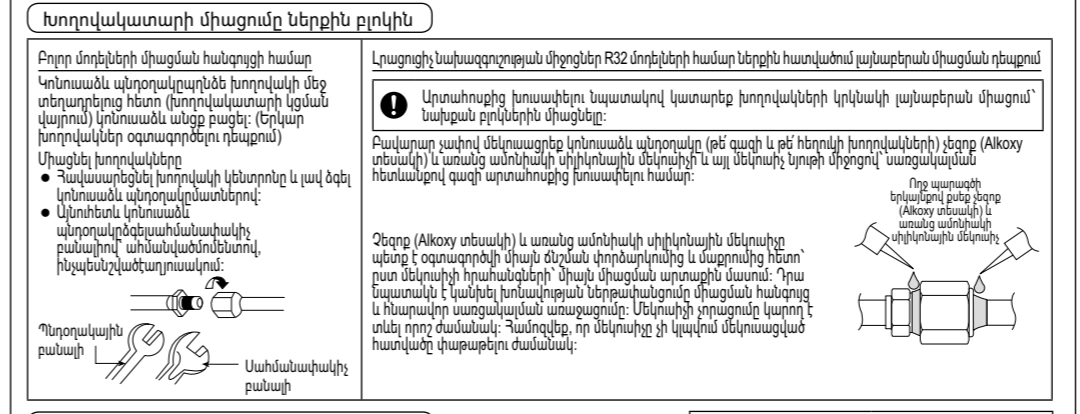

4 ՄԱՌԱՐԱՆԱՅԻՆ ՀԱՍՏԱՎԱՐԳԵՐԻ ԴՅՈՒՄՆԵՏԻՎԻՏԻՎԱԿԱՆ ԱՏՈՒԳՈՒՄ

